

ZÜNDAPP



CATALOGUE OF SPARE PARTS

ZÜNDAPP GS 125

Type 520-05L0, engine 285-20L0

Varnish for Vehicles: racing-red, index No. 60

Table of Contents

<u>Engine</u>	<u>Page</u>
Casing left	2
Casing right	3
Casing cover left, kickstarter	4
Cylinder, crankshaft	5
Casing cover right, clutch	7
Carburettor, suction socket	9
Gearbox, chain pinion	10
Gear change shaft	11
CDI-system	12
Exhaust system	13
<u>Frame</u>	
Frame, noise damper, foot rests	14
Engine mounting, foot brake, centre prop	15
Telescopic fork, handlebar bearing	17
Rear fork, chain guard, spring unit	18
Front wheel	19
Rear wheel, chain	21
Electrical equipment	23
Handlebar, operating levers and controls, cables	25
Fairings, mounting bracket, fuel tank, bench seat, mirror	27
Tin repair varnish, illustration of motorcycle	28

For reference numbers followed by "colour" index no. has to be indicated (e.g. 520-10.613/60).

Casing left

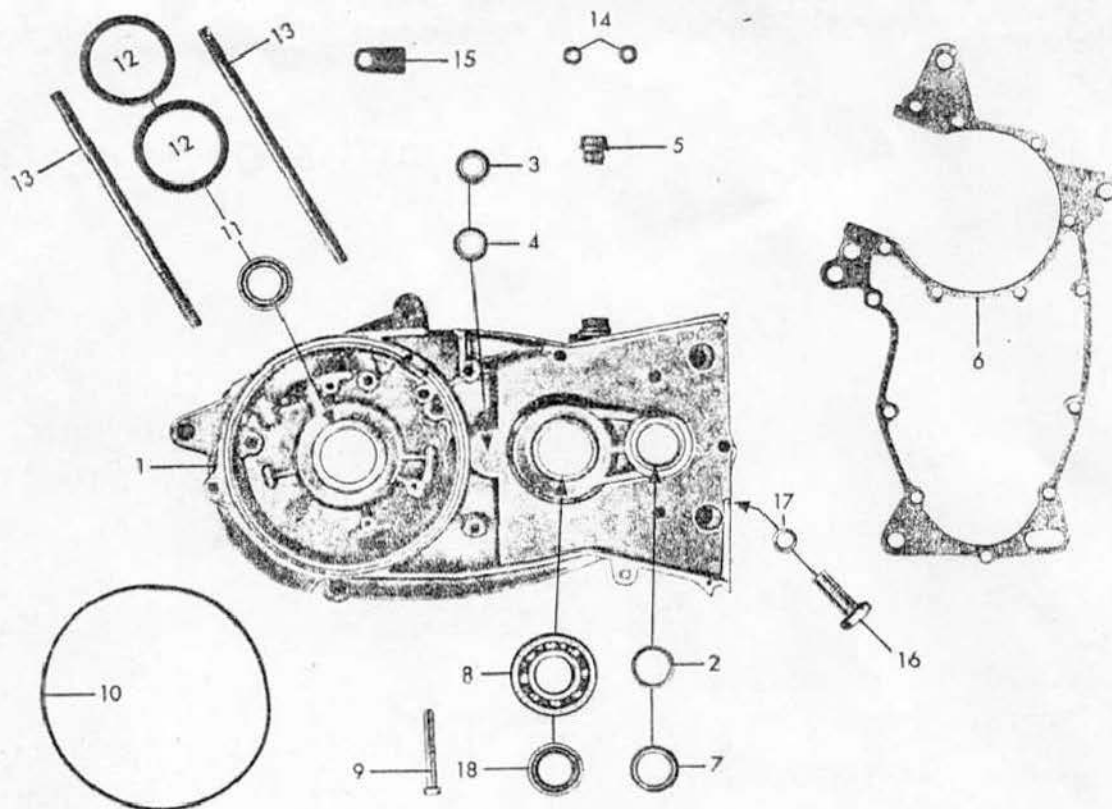

Jll.-No.	Order No.	Description	Piece
1-5	285-01.921	Casing left	1
2	285-01.203	Bearing bush 20 mm ϕ	1
3	285-01.757	Needle sleeve 12x20x13 mm	1
4	285-01.224	Washer 12,3x19,9x1,0 mm	1
5	281-01.135	Oil filler screw	1
6	285-01.901	Housing gasket (when ordering 1 piece, a packet of 5 will be delivered)	1
7	285-01.204	Shaft seal 20x28x6 mm	1
8	DIN 625 6204 C3	Ball bearing 20x47x14 mm	1
9	DIN 84 BM 6x45	Cylinder bolt	2
10	285-01.192	Rubber ring 123 ϕ x 2,5 mm	1
11	285-01.194	Shaft seal 20x30x7 mm	1
12	285-01.210	Washer 42x51,9x0,05 mm	var.
12	285-01.211	Washer 42x51,9x0,1 mm	var.
12	285-01.212	Washer 42x51,9x0,2 mm	var.
13	285-01.197	Threaded bolt	2
14	M 181 z 138	Press-fit bush	4
15	285-07.126	Cable sleeve	1
16	285-05.208	Screw SW 17, 35 mm long	1
17	DIN 7603 A 10x14	Sealing ring	1
18	285-01.183	Shaft seal 20x30x7/1 mm	1

Cacing right

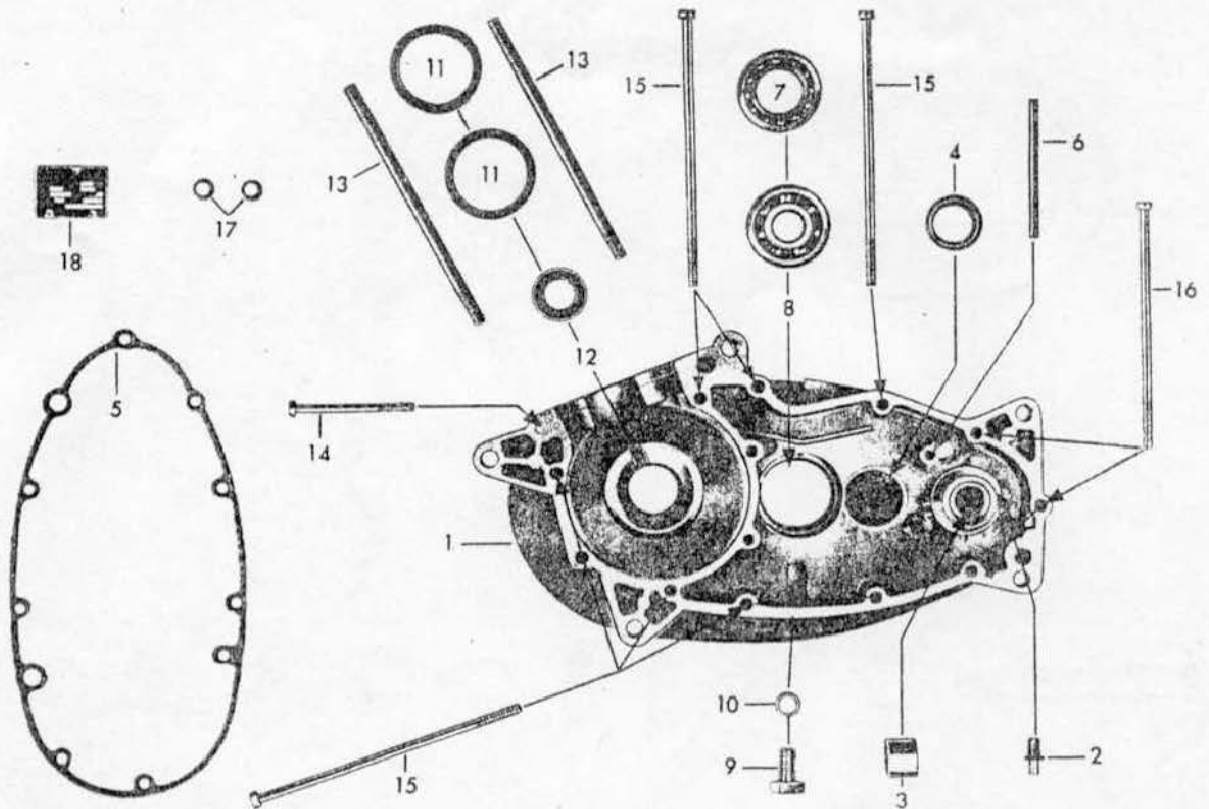

Ill.-No.	Order No.	Description	Piece
1-4	285-01.919	Casing right	1
2	285-01.164	Stud	1
3	267-01.128	Bearing bush 16 ϕ	1
4	281-01.140	Bearing bush 21,5/31 mm ϕ	1
5	285-01.902	Housing gasket (when ordering 1 piece, a packet of 5 will be delivered)	1
6	DIN 1481 5x80	Clamping sleeve	1
7	DIN 625 16005 C3	Ball bearing 25x47x8 mm	1
8	DIN 625 6303 C3	Ball bearing 17x47x14 mm	1
9	DIN 933 M 10x18	Oil drain plug	1
10	DIN 7603 A 10x14	Sealing ring	1
11	285-01.210	Washer 42x51,9x0,05 mm	var.
11	285-01.211	Washer 42x51,9x0,1 mm	var.
11	285-01.212	Washer 42x51,9x0,2 mm	var.
12	285-01.220	Shaft seal 20x30x8/1 mm	1
13	285-01.197	Threaded bolt	2
14	DIN 84 BM 6x65x20	Cylinder bolt	1
15	285-01.180	Cylinder bolt M 6x154 mm	8
16	285-01.181	Cylinder bolt M 6x140 mm	3
17	M 181 z 138	Press-fit bush	2
18	247-01.126	Model plate	1
--	DIN 1476 2x3	Round-head	2

Casing cover left, kickstarter

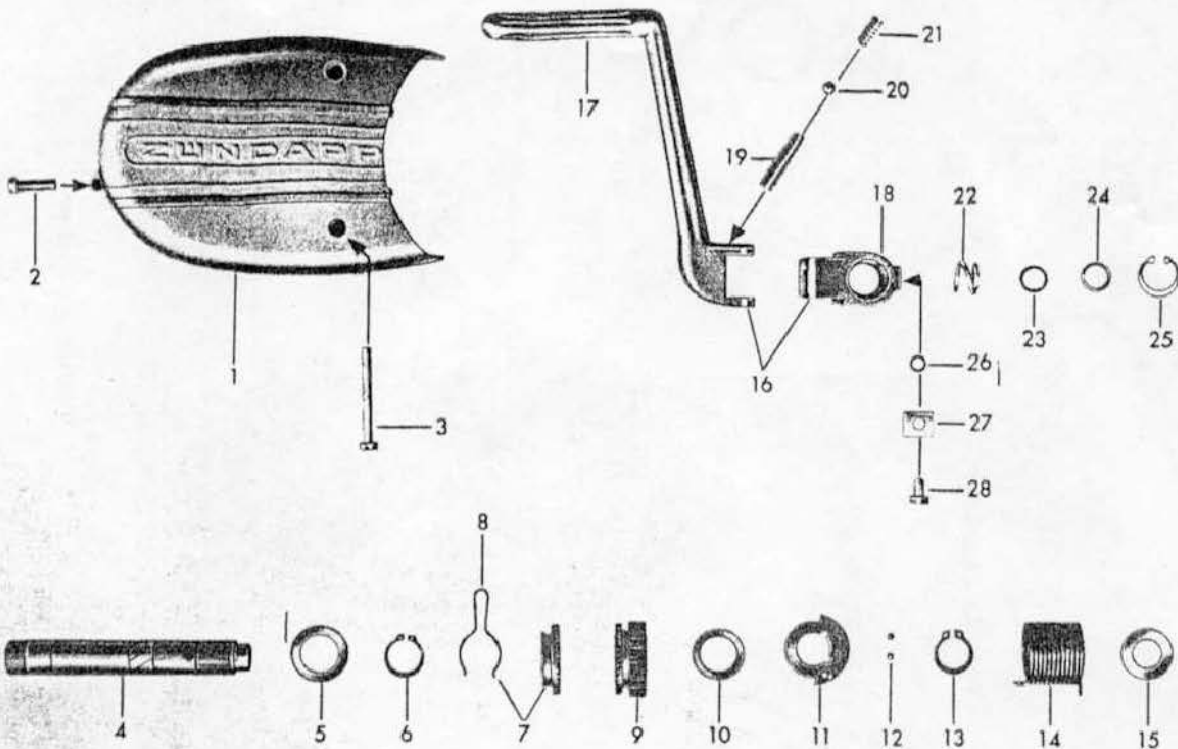

Jll.-No.	Order No.	Description	Piece
1	285-01.177	Casing cover left	1
2	DIN 84 BM 6x22	Cylinder bolt	1
3	DIN 84 BM 6x55	Cylinder bolt	2
4	285-05.235	Kickstarter spindle single	1
5	265-05.255	Washer 22,1x32x0,2 mm	var.
5	265-05.257	Washer 22,1x32x0,3 mm	var.
6	DIN 471 20x1,2	Retaining ring	1
7	267-05.910	Dog cpl.	1
8	267-05.334	Brake spring	1
9	285-05.169	Starter gear	1
10	267-05.312	Washer 20,2x28x1,0 mm	2
10	267-05.310	Washer 20,2x28x0,1 mm	var.
10	267-05.313	Washer 20,2x28x0,5 mm	var.
10	267-05.315	Washer 20,2x28x0,2 mm	var.
11	285-05.209	Starter buffer	1
12	DIN 5401 5 ϕ	Ball	2
13	DIN 471 20x1,75	Retaining ring	1
14	285-05.207	Spring	1
15	265-05.245	Washer 16,2x28x1,0 mm	1
16	285-05.665	Kickstarter lever cpl.	1
17	285-05.234	Kickstarter lever single	1
18	285-05.303	Kickstarter sleeve single	1
19	DIN 7 8x6x36	Cylinder pin	1
20	DIN 5401 8 ϕ	Ball	1
21	267-05.319	Spring	1
22	285-05.299	Spring	1
23	285-05.302	O-Ring 12 ϕ x 2 mm	1
24	285-05.300	Washer 12,1x16,5x1,0 mm	1
25	DIN 472 22x1	Retaining ring	1
26	285-05.178	Retaining sheet	1
27	DIN 7603 A 6,5x9,5	Sealing ring	1
28	285-05.211	Screw SW 11	1

Cylinder, crankshaft

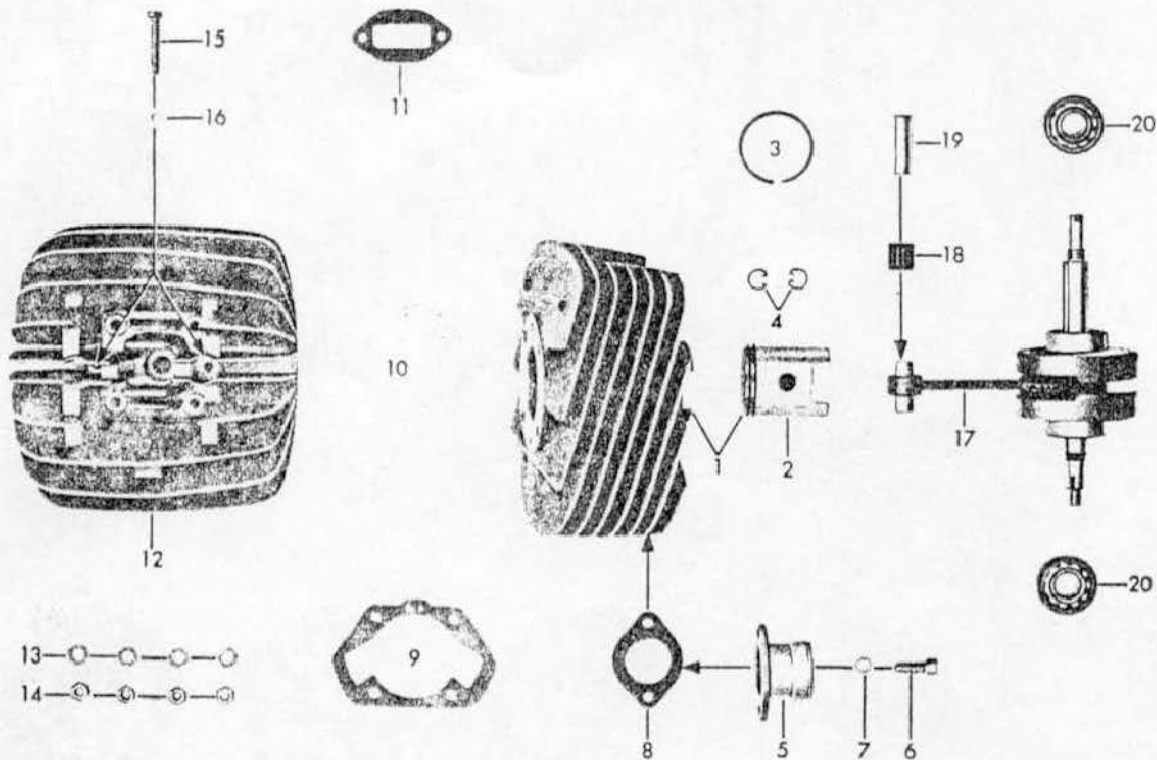

Jll.-No.	Order No.	Description	Piece
1	285-02.736	Cylinder with piston	1
2	285-02.729	Piston cpl. (<u>Different tolerances!</u> Indicate tolerance letter being stamped on the cylinder head)	1
3	285-02.176	Piston ring	2
4	DIN 73123 15x1,2	Snap ring	2
5	285-02.637	Flange	1
6	DIN 912 M 8x25	Cylinder bolt	2
7	DIN 433 8,4	Washer	2
8	285-02.162	Gasket	1
9	285-02.152	Cylinder gasket	1
10	285-02.153	Cylinder head gasket	1
11	285-04.108	Gasket for suction socket	1
12	285-02.173	Cylinder head	1
13	DIN 1440 8 ϕ	Washer	4
14	DIN 934 M 8	Hexagon nut	4
15	DIN 931 M 7x45	Hexagon bolt	2
16	DIN 125 A 7,4	Washer	2
17	285-03.907	Crankshaft cpl.	1
18	285-03.139	Needle cage 15x19x20 mm	1
19	285-03.120	Piston pin 15 mm ϕ	1
20	285-03.905	Ball bearing 20x52x15 mm	2

Casing cover right, clutch

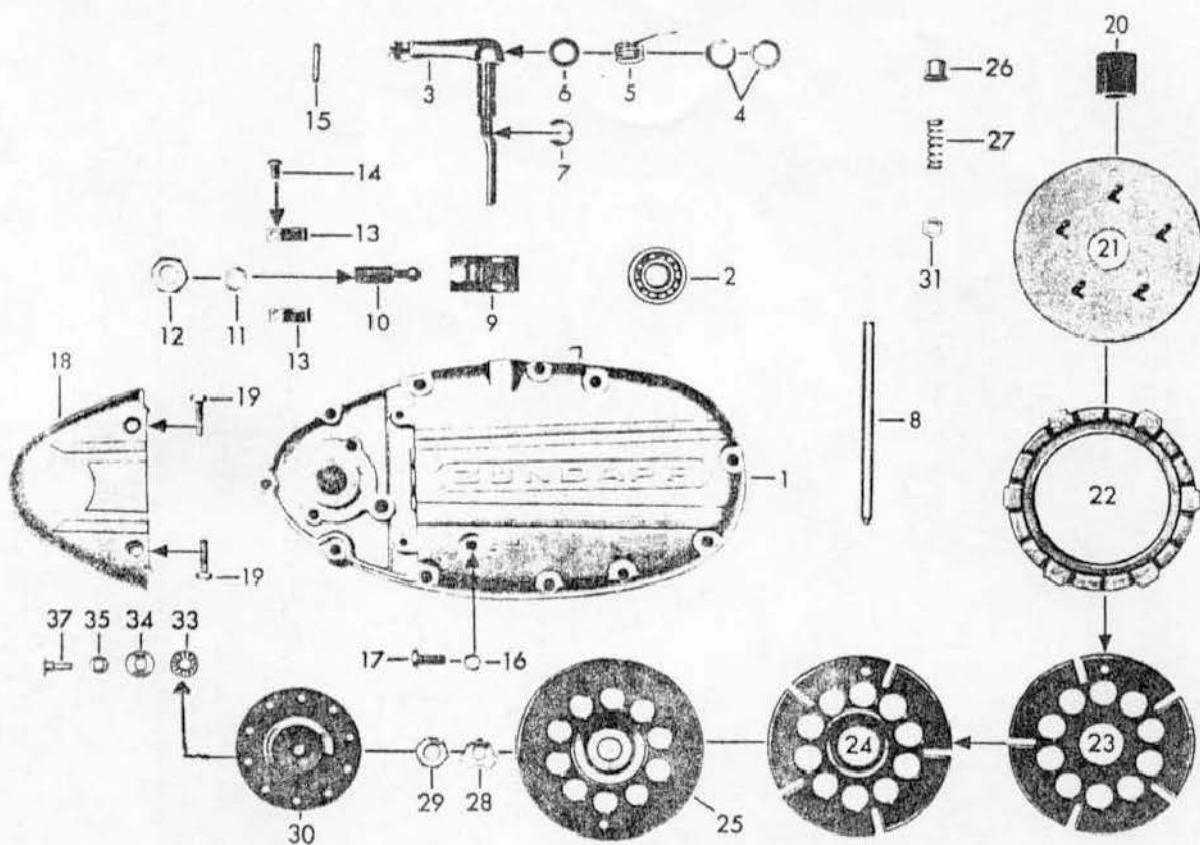

Jll.-No.	Order No.	Description	Piece
1	285-01.922	Casing cover right	1
2	DIN 625 6201 C3	Ball bearing 11x32x10 mm	1
3	265-06.602	Clutch lever	1
4	281-06.114	Washer 0,2 mm thick	1
4	281-06.115	Washer 0,5 mm thick	var.
5	265-06.112	Spring	1
6	405-15.388	Gasket	1
7	DIN 16799 8	Retaining washer	1
8	285-05.325	Guide bolt with groove	1
-	DIN 471 8x0,8	Retaining ring	1
9	265-06.104	Clutch tongue	1
10	265-06.106	Set screw	1
11	DIN 17603 A 10x14	Sealing ring	1
12	DIN 936 M 10x1	Hexagon nut	1
13	265-06.109	Retaining spring	2
14	DIN 84 AM 4x6	Cylinder bolt	2
15	DIN 1481 3x12	Tension bolt	1
16	DIN 7603 A 6x10	Sealing ring	1
17	DIN 85 AM 6x12	Oval-head screw	1
18	285-01.105	Connector cap	1
19	DIN 964 AM 5x20	Oval-head screw	2
20	285-06.101	Pinion	1
21	285-06.603	Retaining plate	1
22	281-06.166	Disk	6
23	265-06.131	Clutch plate	1
24	265-06.130	Clutch plate	4
25	265-06.127	Cover plate	1
26	261-06.155	Spring sleeve	10
27	285-06.107	Clutch spring	10
28	284-06.104	Retaining sheet	1
29	265-06.202	Hexagon nut	1
30	285-06.108	Thrust plate	1
31	DIN 934 M4	Hexagon nut	5
33	285-06.115	Needle bearing 10x24 mm	1
34	285-06.116	Washer 10x24x1 mm	1
35	285-06.111	Washer 10,1x18x0,1 mm	1
35	285-06.112	Washer 10,1x18x0,2 mm	var.
35	285.06.113	Washer 10,1x18x0,4 mm	var.
35	285-06.114	Washer 10,1x18x0,8 mm	var.
37	285-06.109	Thrust pin	1

Carburettor, suction socket

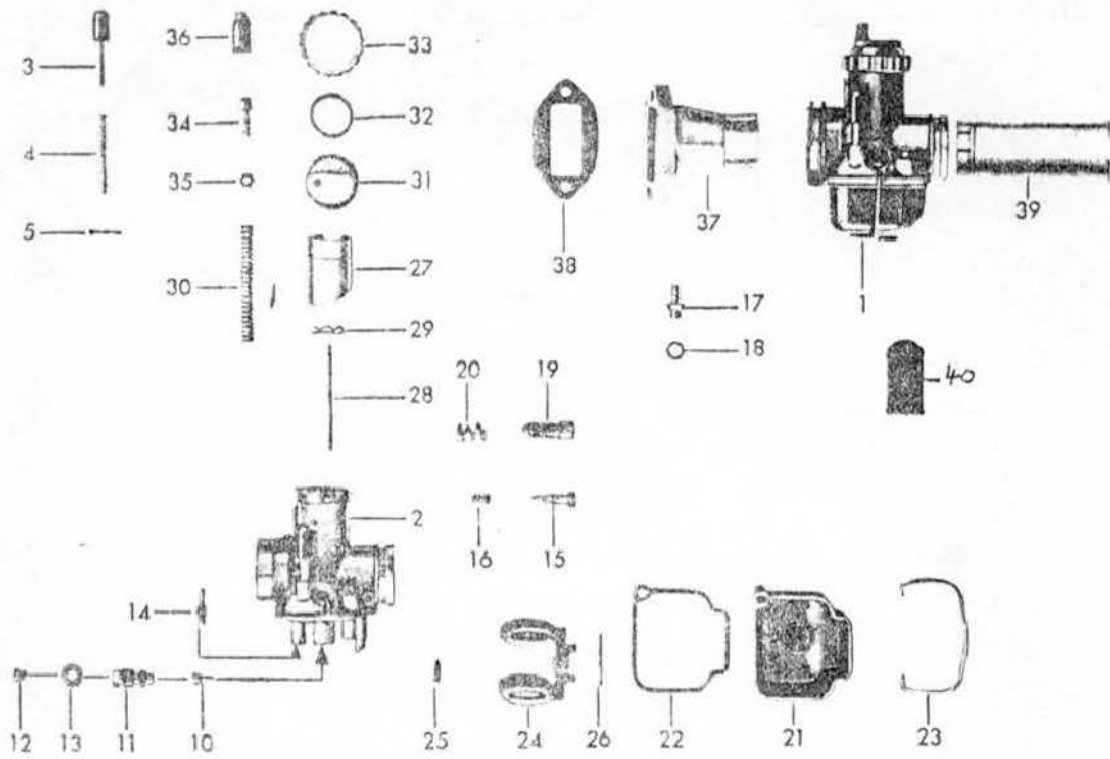

Jll.-No.	Order No.	Description	Piece
1	285-04.726	Carburettor cpl. 2/27/10	1
-	285-04.202	Bush 27x35x20,4x1 mm	1
-	285-04.197	Rubber sleeve 37,5 mm ϕ , 32,5 mm long	1
2	285-04.959	Carburettor housing 2/27/10	1
3	285-04.908	Priming button	1
4	276-04.920	Priming button spring	1
5	276-04.916	Split pin	1
10	285-04.937	Needle jet size 2.70	var.
10	285-04.936	Needle jet size 2.73	1
10	285-04.938	Needle jet size 2.76	var.
11	285-04.912	Choke tube	1
12	285-04.961	Main jet size 118	var.
12	285-04.950	Main jet size 120	var.
12	285-04.964	Main jet size 123	1
12	285-04.951	Main jet size 125	var.
12	285-04.960	Main jet size 130	var.
13	285-04.913	Washer	1
14	285-04.901	Idle running jet 35	var.
14	285-04.902	Idle running jet 40	1
15	220-04.904	Air regulation screw	1
16	285-04.915	Spring	1
17	267-04.940	Hose grommet	1
18	267-04.946	Sealing ring	1
19	285-04.916	Set screw	1
20	285-04.917	Spring	1
21	285-04.957	Float housing with tube	1
22	285-04.919	Gasket	1
23	285-04.920	Spring	1
24	285-04.921	Float	1
25	285-04.922	Float needle	1
26	285-04.923	Pin	1
27	285-04.958	Gas slide	1
28	285-04.947	Jet needle	1
29	285-04.952	Clamp	1
30	285-04.953	Sliede spring	1
31	285-04.973	Cover plate	1
32	285-04.931	Rubber sealing ring	1
33	285-04.954	Cover screwing	1
34	267-04.938	Adjuster screw	1
35	251-04.927	Nut	1
36	517-17.111	Rubber sleeve	2
37	285-04.196	Suction socket	1
38	285-04.108	Gasket for suction socket	1
--	DIN 433 6,4	Washer	2
--	DIN 934 M 6	Hexagon nut	2
39	285-04.185	Tube	1
40	285-04.941	Gas slide	1
--	285-04.967	Filter body for Float housing	1

Some illustrations are not identical
with the parts.

Gearbox

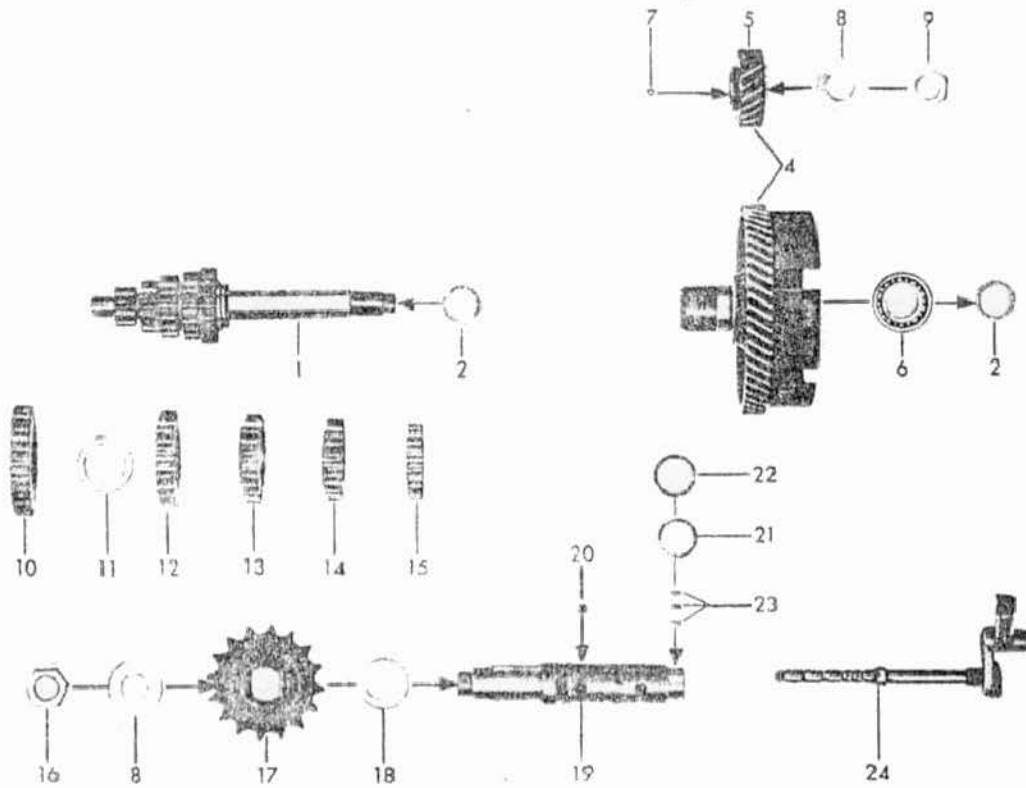

Jll.-No.	Order No.	Description	Piece
1	285-05.637	Drive shaft	1
2	265-05.178	Washer 17,1x23x0,95 mm	var.
2	265-05.177	Washer 17,1x23x0,1 mm	var.
2	265-05.176	Washer 17,1x23x0,2 mm	var.
2	265-05.175	Washer 17,1x23x0,5 mm	var.
2	265-05.179	Washer 17,1x23x0,8 mm	var.
4	285-05.903	Clutch wheel cpl.	1
5	286-05.102	Pinion single	1
6	DIN 625 6003	Ball bearing 17x35x10 mm	1
7	DIN 5401 5 ϕ	Ball	2
8	276-05.198	Washer 15,2x30x0,75 mm	2
9	285-05.151	Hexagon nut M 15x1 (lefthand thread)	1
10	285-05.243	Gear wheel f. 1st speed 34 t.	1
11	265-05.256	Washer 22,1x32x0,1 mm	var.
11	265-05.255	Washer 22,1x32x0,2 mm	var.
11	265-05.257	Washer 22,1x32x0,3 mm	var.
12	285-05.242	Gear wheel f. 2nd speed 26 t.	1
13	285-05.241	Gear wheel f. 3rd speed 23 t.	1
14	285-05.239	Gear wheel f. 4th speed 24 t.	1
15	285-05.237	Gear wheel f. 5th speed 19 t.	1
16	276-05.119	Hexagon nut M 15x1 (righthand thread)	1
17	285-05.286	Chain pinion 12 teeth	var.
17	285-05.199	Chain pinion 13 teeth	1
17	285-05.200	Chain pinion 14 teeth	var.
17	285-05.201	Chain pinion 15 teeth	var.
18	267-05.310	Washer 20,2x28x0,1 mm	var.
18	267-05.315	Washer 20,2x28x0,2 mm	var.
18	267-05.312	Washer 20,2x28x1,0 mm	1
19	285-05.609	Selector shaft single	1
20	278-05.101	Ball 7 mm ϕ	20
21	281-05.152	Distance ring 18,1x23,5x1 mm	1
22	285-05.153	Distance ring 19,1x24,9x1 mm	1
23	DIN 5402 3,5x5	Roller	19
24	283-05.608	Full cotter cpl.	1

Gear change shaft

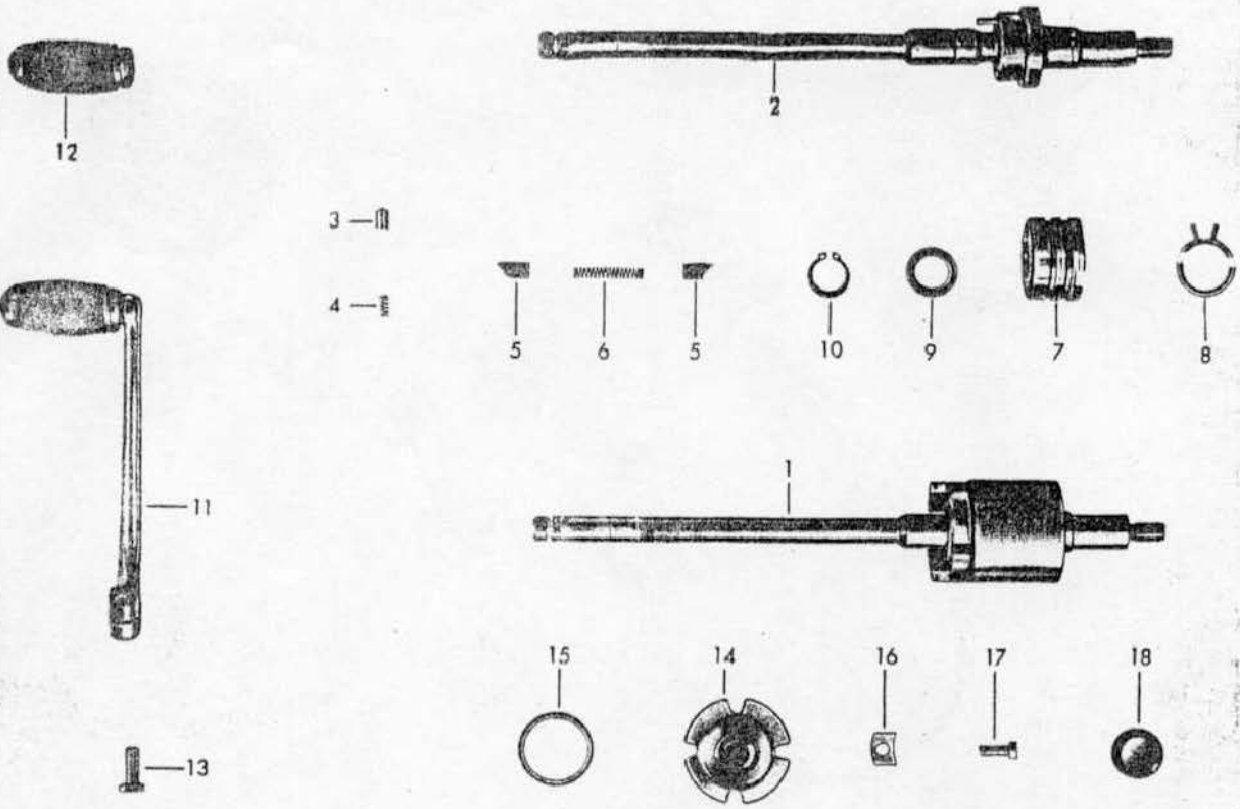

Jll.-No.	Order No.	Description	Piece
1	285-05.723	Gear change shaft cpl.	1
2	285-05.667	Gear change shaft single	1
3	267-05.125	Bolt	1
4	267-05.126	Spring	1
5	267 ²⁸⁵ -05.307	Latch	2
6	267-05.585	Spring	1
7	285-05.310	Pawl guide rail	1
-	DIN 660 2,6x5	Rivet	1
8	278-05.100	Return spring	1
9	267-05.244	Washer 16,2x22,8x0,1 mm	var.
10	DIN 471 16x1	Retaining ring	1
11	old: * 282-05.700	Foot shift lever cpl. (<i>bent version</i>)	1
12	616 z 25	Rubber sleeve	1
13	DIN 933 M 6x16	Hexagon bolt	1
14	267-05.112	Setting bell	1
15	285-05.322	O-Ring	1
16	267-05.113	Shim	2
17	DIN 920 M 6x15	Oval-head screw	2
18	267-05.130	Rubber cap	1
11 new:	* 283-05.716	Foot shift lever cpl. (<i>straight version</i>)	1

CDI-system

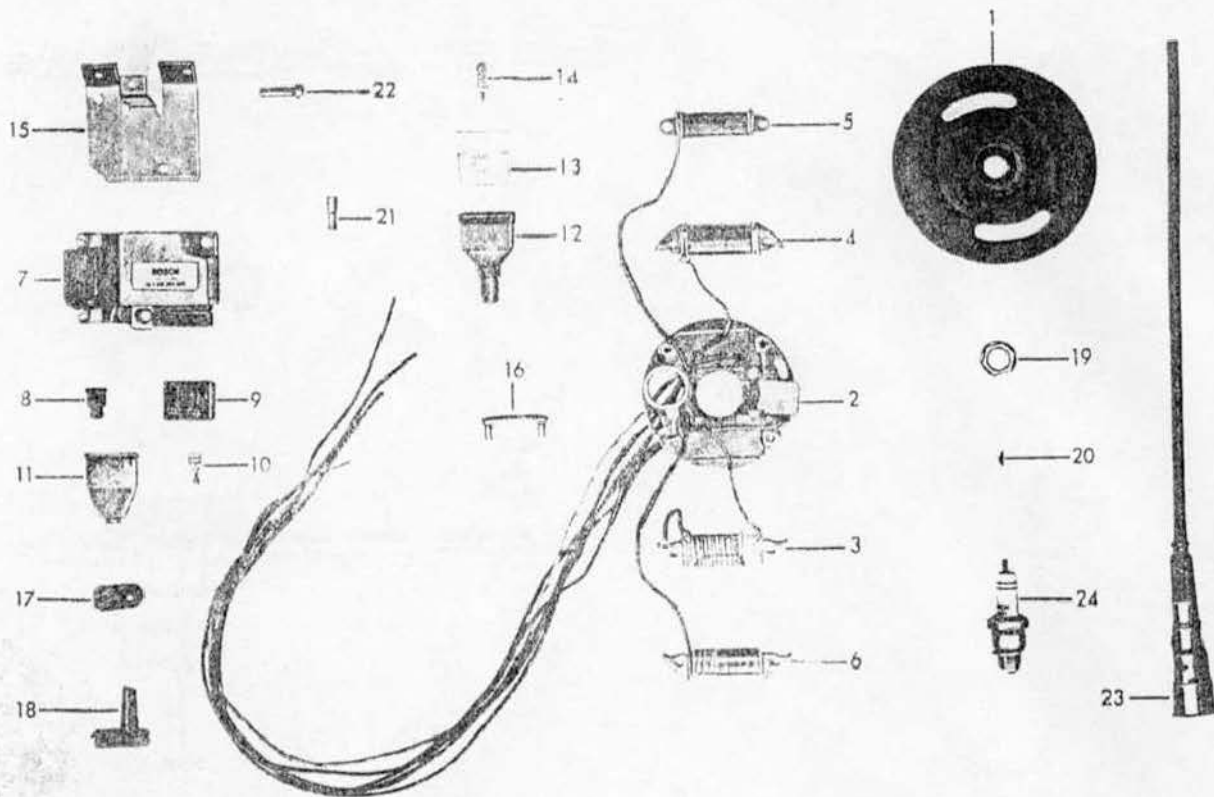

Jll.-No.	Order No.	Description	Piece
-	285-07.729	CDI-system 58 W cpl.	1
1	285-07.906	Flywheel single	1
2	285-07.907	Armature plate cpl.	1
3	284-07.904	Charging generator armature	1
4	285-07.903	Lighting coil 35 W	1
5	285-07.905	Rear light coil 5 W	1
6	285-07.904	Charging coil 18 W	1
7	284-07.907	Electronic box	1
8	265-07.914	Protecting cap	1
9	285-07.143	Plug housing	1
10	304-07.249	Plug sleeve	4
11	285-07.139	Protecting cap	1
12	304-16.242	Cap	1
13	304-16.216	Flat plug contact housing	1
14	304-16.204	Flat plug contact	5
15	285-07.140	Mounting bracket	1
16	285-07.129	Retaining plate	1
17	285-07.105	Cable grommet	1
18	283-07.100	Cable grommet	1
19	285-07.135	Nut with collar M 12x1 (SW 17)	1
20	DIN 6888 3x3,7	Plate spring	1
--	DIN 125 A 4,3	Washer	2
--	DIN 84 AM 4x16	Cylinder bolt	2
21	520-16.256	Round plug sleeve	2
22	DIN 84 AM 6x22	Cylinder bolt	2
--	DIN 125 A 6,4	Washer	2
--	DIN 934 M 6	Hexagon nut	2
23	285-07.732	Interference-suppressor plug	1
24	285-07.114	Spark plug M 280 W 1	1

Exhaust system

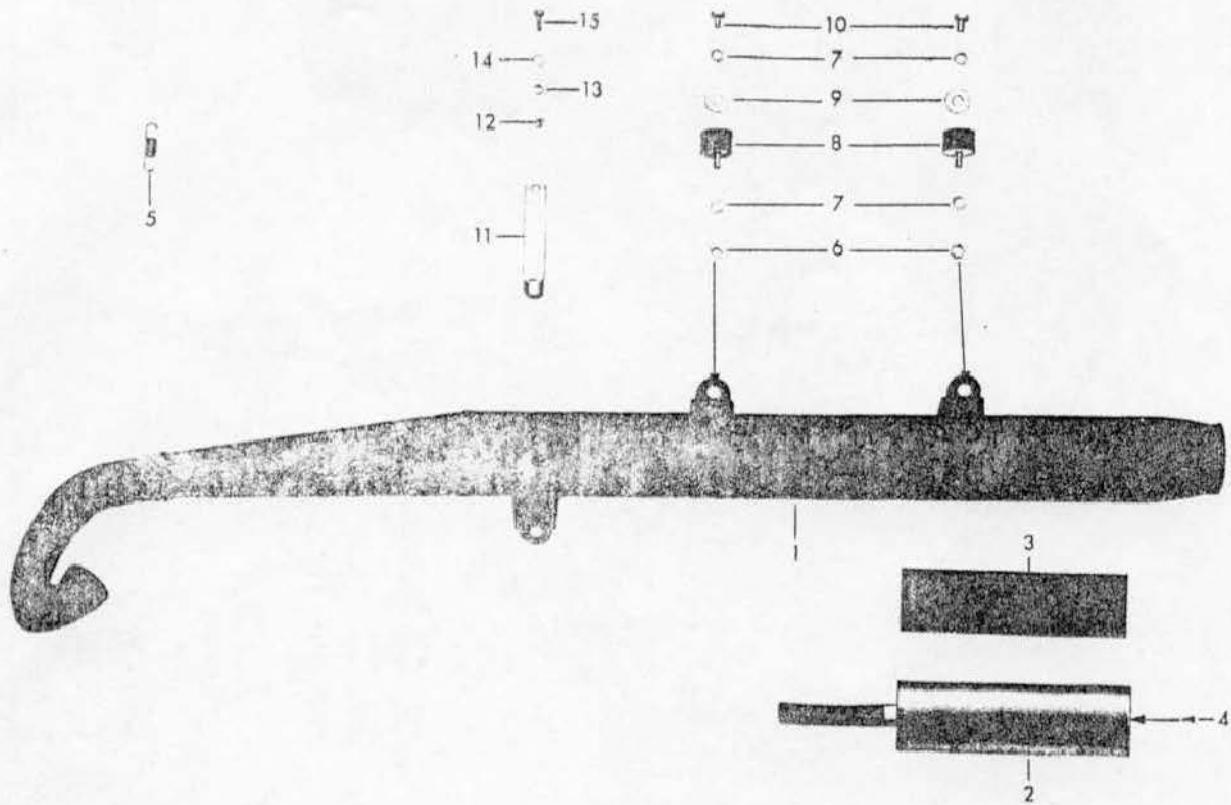

Jll.-No.	Order No.	Description	Piece
1	520-22.714	Exhaust silencer cpl.	1
2	520-22.906	Damper tube single	1
3	520-22.907	Pressed article	1
4	DIN 933 M 6x10	Hexagon bolt	1
-	520-22.908	Retaining sheet	1
5	517-15.127	Draw spring	2
6	DIN 934 M 8	Hexagon nut	3
7	DIN 127 B 8	Spring washer	6
8	520-10.288	Swing suspension buffer	3
9	DIN 9021 A 8,4	Washer	3
10	DIN 933 M 8x12	Hexagon bolt	3
11	520-22.139	Exhaust holder	1
12	DIN 934 M 6	Hexagon nut	1
13	DIN 127 B 6	Spring washer	1
14	DIN 125 A 6,4	Washer	1
15	DIN 933 M 6x16	Hexagon bolt	1
--	520-22.114	Asbestos cord 1,5 mm ϕ x 264 mm	1

Frame, damper, foot rests

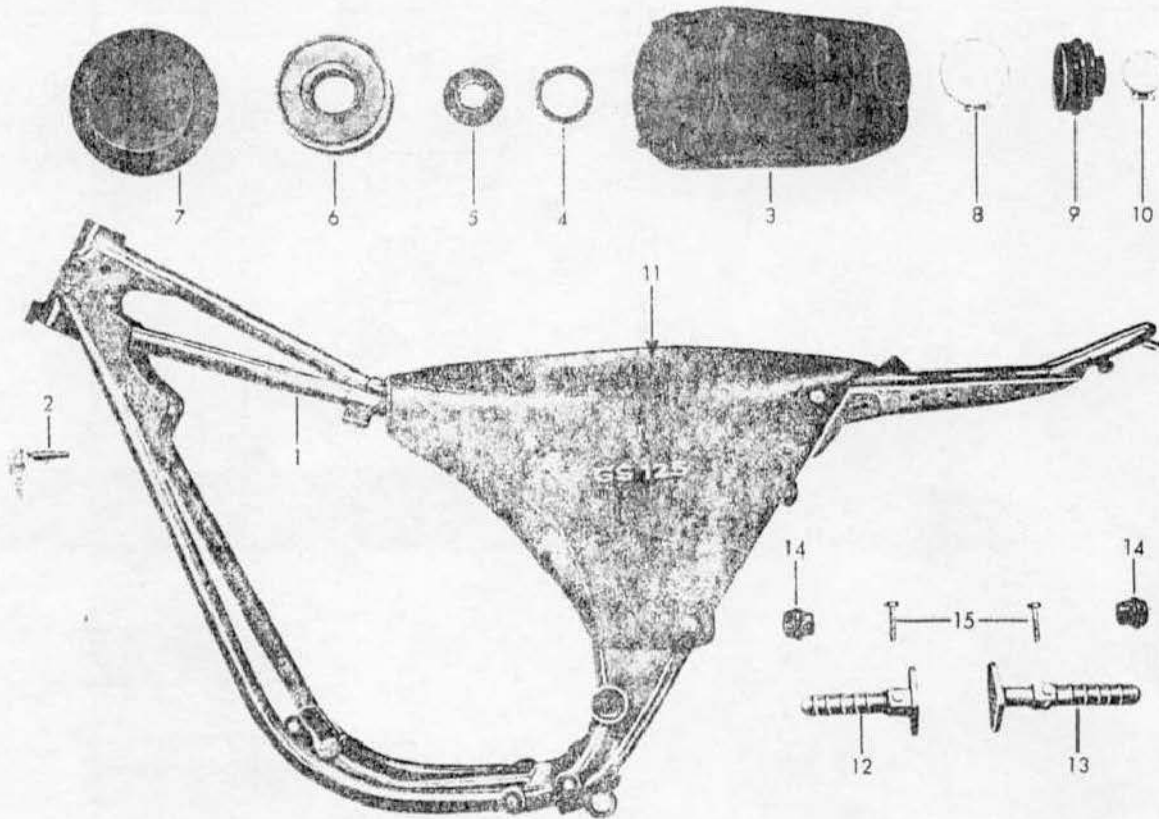

Jll.-No.	Order No.	Description	Piece
1	520-10.613 <u>colour</u>	Frame (without cover for GS 125)	1
2	517-10.710	Lock set	1
3	520-10.717	Noise damper cpl.	1
4	520-10.379	Sealing ring 59 mm ϕ	1
5	520-10.324	Sealing ring 34,8 mm ϕ	1
6	520-10.608	Filter insert	1
7	520-10.901	Filter cover cpl.	1
--	DIN 7971 BZ 4,2x6,5	Cylinder bolt	1
8	520-10.318	Hose clip S 76/9 mm	1
9	520-10.317	Bellow	1
10	520-10.703	Hose clip S 46/9 mm	1
11	520-10.674	Cover for GS 125	1
--	520-10.253	Snap fastener	4
--	DIN 84 AM 4x6	Cylinder bolt	4
12	520-14.731	Foot rest left	1
13	520-14.732	Foot rest right	1
14	520-14.241	Rubber sleeve	2
15	DIN 931 M 8x42x22	Hexagon bolt	2
--	DIN 127 B 10	Spring washer	4
--	DIN 934 M 10	Hexagon nut	4
--	435-10.900	Model plate (indicate frame No.)	1
--	DIN 1476 2x5	Pin	2

Engine mounting, foot brake, centre prop

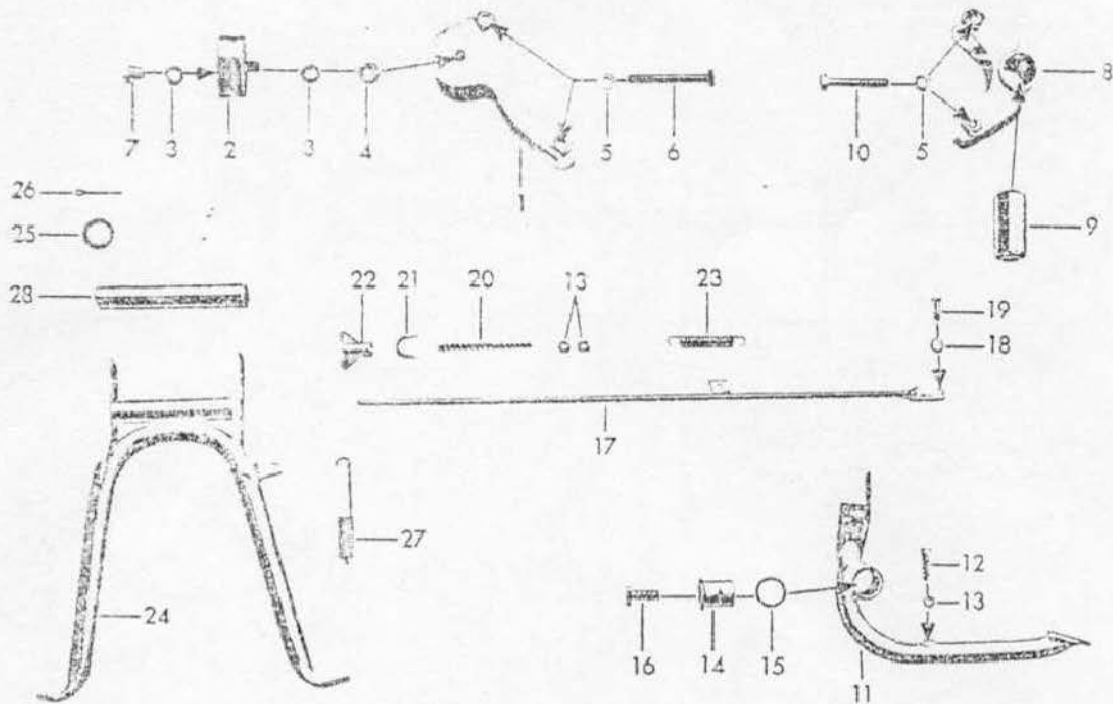

Jll.-No.	Order No.	Description	Piece
1	520-18.615 r	Engine support	1
2	520-18.613	Rubber-metal buffer	2
3	DIN 127 B 10	Spring washer	4
4	DIN 934 M 10	Hexagon nut	2
5	DIN 127 B 8	Spring washer	5
6	DIN 931 M 8x70	Hexagon bolt	2
7	DIN 933 M 10x12	Hexagon bolt	2
8+9 +)	520-18.703	Engine mounting rear	1
9	520-14.627	Elastic bush	1
10	DIN 931 M 8x55	Hexagon bolt	2
11	520-17.609	Foot brake lever	1
12	DIN 933 M 6x22	Hexagon bolt	1
13	DIN 934 M 6	Hexagon nut	3
14	520-17.179	Bearing sleeve	1
15	520-17.141	Ring	2
16	DIN 931 M 8x35	Hexagon bolt	1
--	DIN 7346 3x12	Clamping sleeve	1
17	520-17.619	Brake linkage	1
18	DIN 125 A 6,4	Washer	1
--	DIN 94 2x12	Split pin	1
19	519-17.106	Pin	1
20	519-17.110	Spring	1
21	433-17.100	Retaining sheet	1
22	428-17.103	Wing nut	1
23	517-17.103	Pull spring	1
24	520-21.606	Prop	1
25	517-21.113	Washer 19,3x26,8x0,5 mm	2
--	517-17.110	Washer 18,2x25,7x0,2 mm	var.
--	520-14.248	Washer 18,5x26x1 mm	var.
26	DIN 94 3x30	Split pin	2
27	517-21.109	Draw spring	1
28	520-21.106	Bearing tube	1

+ please use together with washer 520-18.110

Telescopic fork, steering set

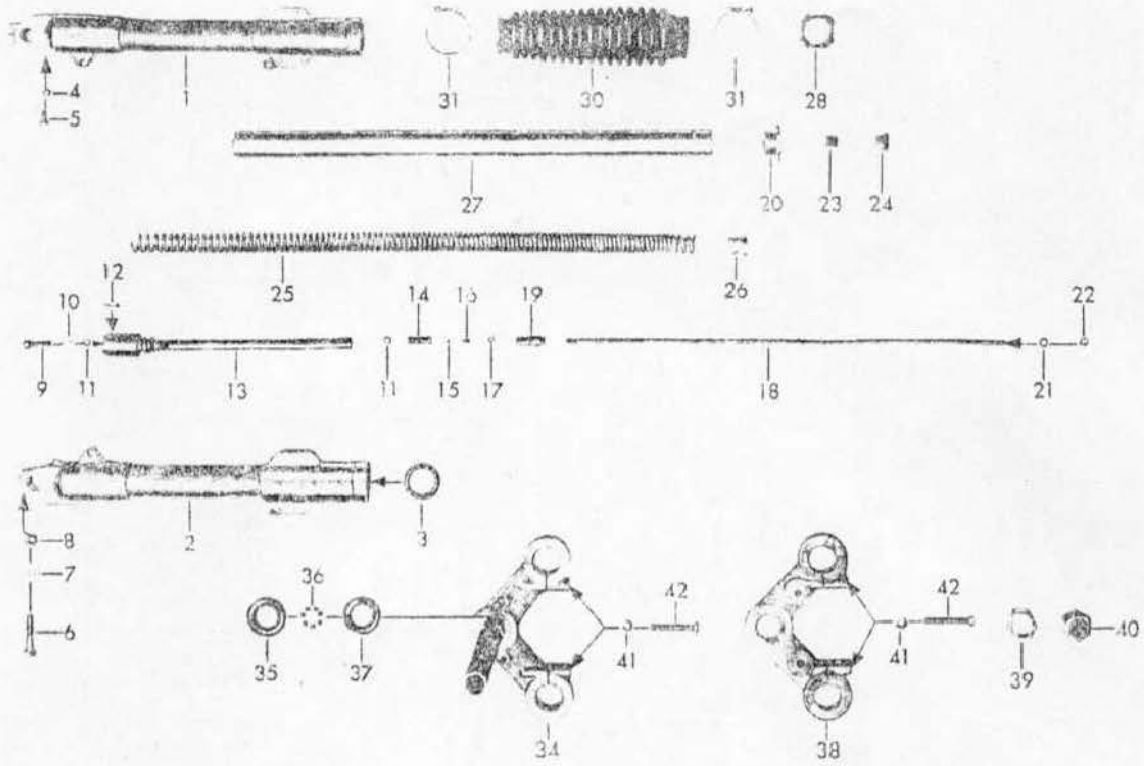

Jll.-Nr.	Order No.	Description	Piece
-	520-12.900	Telescopic fork spl.	1
1	520-12.720	Fork breaking left, with illustration No. 3, 4, 5	1
2	520-12.721	Fork breaking right, with illustration No. 3, 4, 5	1
3	520-12.225	Shaft seal QH 32x42 G2/51	2
4	DIN 7603 A 6x10	Sealing ring	2
5	DIN 933 M 6x12	Hexagon bolt	2
6	DIN 934 M 8x40	Hexagon bolt	2
7	DIN 125 A 8,4	Washer	2
8	561-17.111	Locking nut M 8x1	2
9	DIN 912 M 6x25	Cylinder bolt	2
10	DIN 433 6,4	Washer	2
11	520-12.271	O-Ring 6 mm ϕ x 1,5 mm	4
12	DIN 1481 4x10	Clamping sleeve	2
13	520-12.660	Damper tube	2
14	520-12.265	Piston	2
15	DIN 5401 4,5 ϕ	Ball	2
16	520-12.267	Draw spring	2
17	520-12.266	Hexagon nut	2
18	520-12.264	Threaded bar	2
19	520-12.274	Guide piece	2
20	520-12.198	Locking screw	2
21	DIN 127 B 6	Spring washer	2
22	DIN 934 M 6	Hexagon nut	2
23	520-12.263	Plug	2
24	520-12.199	Locking screw	2
25	520-12.273	Draw spring	2
26	520-12.272	Spring support	2
27	520-12.661	Fork tube	2
28	520-12.257	Rubber ring	2
30	518-12.100	Bellow	2
31	518-12.103	Clamping clip S 48/9 mm	4
34	520-12.635	Fork connection bottom	1
35	1871 z 156	Fork bearing race	2
36	DIN 5401 6 ϕ	Ball	36
37	1871 z 155	Frame bearing race	2
38	520-12.204	Fork connection top	1
39	519-12.110	Cone nut	1
40	520-12.143	Locking nut	1
41	DIN 137 B 7	Spring washer	4
42	DIN 933 M 7x50	Hexagon bolt	4
--	520-12.188	Metal ring, for fork connection bottom	1

Rear fork, chain guard, spring unit

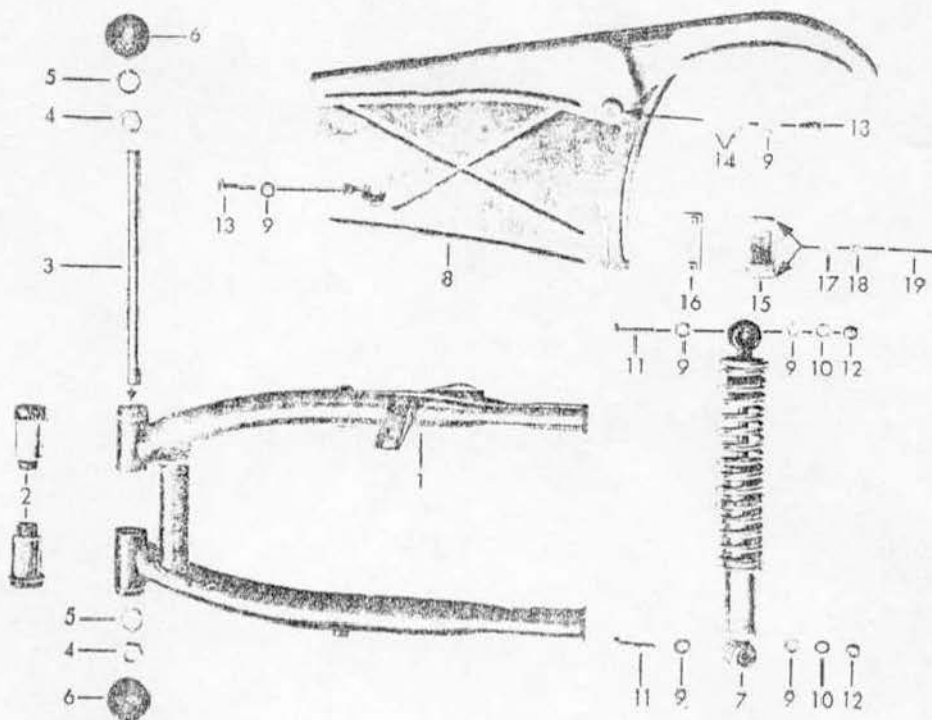

Jll.-Nr.	Order No.	Description	Piece
1	520-14.735 <u>colour</u>	Rear fork	1
2	520-14.627	Elastic bush	2
3	520-14.216	Axle	1
4	520-14.217	Nut	2
5	DIN 127 B 16	Spring washer	2
6	520-14.237	Cap	2
7	520-14.734	Spring unit cpl.	2
-	520-14.733	Chock absorber single	2
-	520-14.266	Draw spring single	2
8	520-14.616	Chain guard	1
9	DIN 125 A 8,4	Washer	4
10	DIN 137 B 8	Spring washer	4
11	DIN 931 M 8x35	Hexagon bolt	4
12	561-17.111	Locking nut M 8	5
13	DIN 933 M 8x16	Hexagon bolt	2
14	520-14.143	Washer 1,8,5x17x1,5 mm	4
15	510-18.218	Chain guide	1
16	520-18.617	Plate	1
17	DIN 125 A 6,4	Washer	2
18	DIN 127 B 6	Spring washer	2
19	DIN 931 M 6x45	Hexagon bolt	2

Front wheel

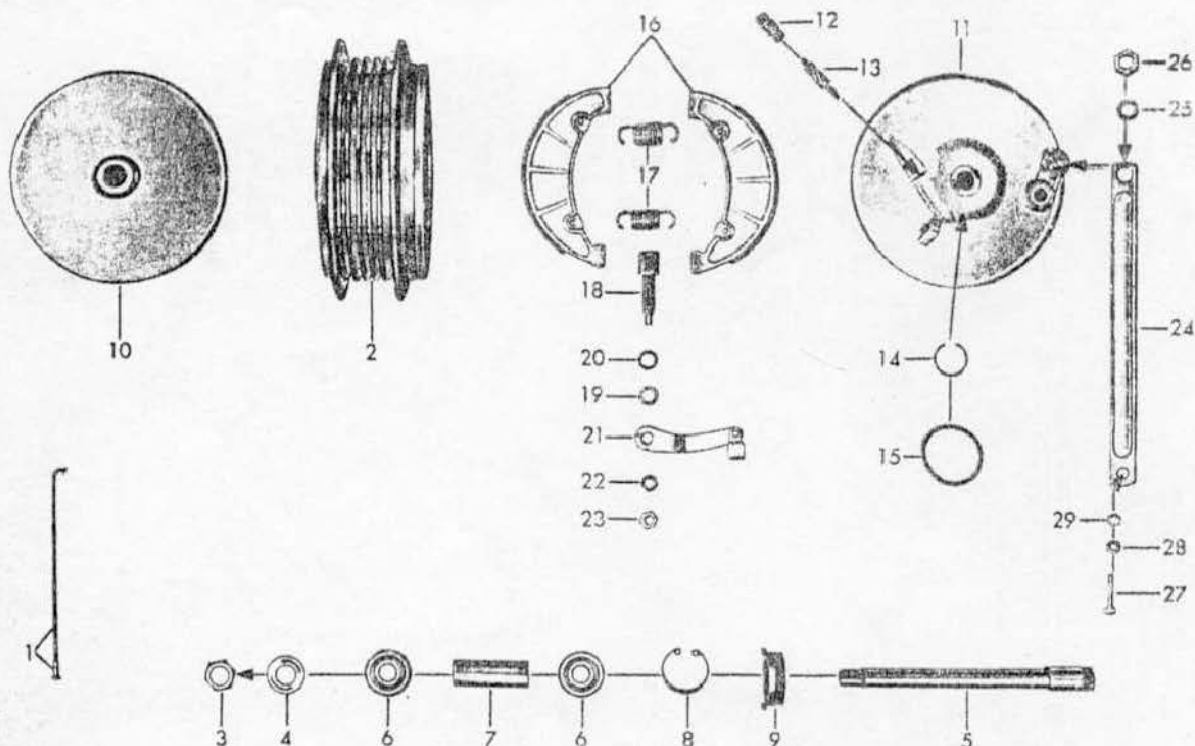

Jll.-No.	Order No.	Description	Piece
-	520-15.201	Rim 1.60 A x 21	1
-	520-15.189	Stell cord tyre 3.00-21 (Gel. D, GS 6)	1
-	520-15.190	Tube 3.00 - 21 (D 21)	1
-	520-15.191	Tube bandage 18-19"/27	1
1	520-15.203	Inner spoke, length 226/12,5 mm	18
1	520-15.204	Outer spoke, length 226/13,5 mm	18
-	520-15.752	Front wheel hub cpl.	1
2	520-15.609	Hub body, single	1
3	DIN 934 M 14x1,5	Hexagon nut	1
4	DIN 125 A 15	Washer	1
5	520-15.179	Knock-out spindle	1
6	DIN 625 6202 Z/C3	Ball bearing 15x35x11 mm	2
7	520-15.193	Spacer tube	1
8	DIN 472 35x1,5	Retaining ring	1
9	520-15.900	Dog cpl.	1
10	520-15.611	Hub cover single	1
11	520-15.645	Brake plate single	1
12	515-15.100	Threaded socket	1
13	520-15.196	Speedometer pinion	1
14	DIN 9045 25	Circlip	1
15	520-15.195	Felt ring	1
16	517-15.609	Brake shoe (1pair)	1
17	517-15.133	Draw spring	2
18	561-15.620	Brake spindle	1
19	267-05.597	Washer	1
20	405-15.388	Rubber ring	1
21	517-15.607	Brake lever	1
22	DIN 127 B 8	Spring washer	1
23	DIN 936 M 8x1	Hexagon nut	1
24	520-15.177	Strip	1
25	DIN 127 B 10	Spring washer	1
26	DIN 934 M 10	Hexagon nut	1
27	DIN 933 M 6x30	Hexagon bolt	1
29	517-22.111	Locking nut M 6	1

Rear wheel, chain

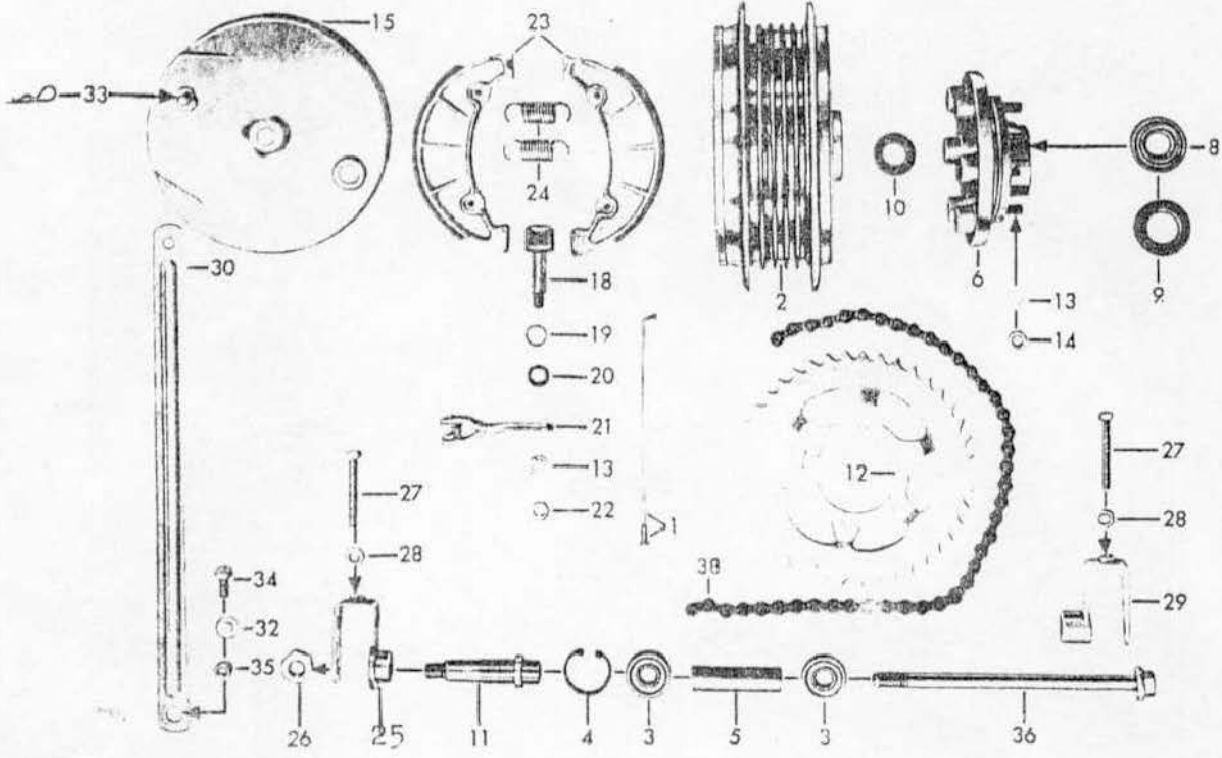

Jll.-No.	Order No.	Description	Piece
-	519-15.123	Rim 1.85 B x 18	1
-	519-15.126	Steel cord tyre 3.50 - 18 (Gel. D)	1
-	519-15.139 521-15.107	Tube E 18	1
-	520-15.186	Tube bandage 18-19"/27	1
1	520-15.207	Inner spoke 159 length x 12,5 mm	18
1	520-15.208	Outer spoke 159 length x 13,5 mm	18
2	520-15.609	Hub body single	1
-	520-15.904	Rear wheel hub cpl. (without chain sprocket)	1
3	DIN 625 6202 z/C3	Ball bearing 15x35x11 mm	2
4	DIN 472 35x1,5	Retaining ring	1
5	520-15.193	Spacer tube 15 mm ϕ	1
6	520-15.902	Hub flange cpl.	1
-	DIN 931 M 8x25x14	Hexagon bolt	6
8	DIN 625 6004 Z	Ball bearing 20x42x12 mm	2
9	520-15.216	Shaft seal 25x42x6/1 mm	1
10	517-15.112	Bush	6
11	520-15.209	Retaining bush	1
12	520-15.155	Chain sprocket 46 teeth	1
13	DIN 127 B 8	Spring washer	6
14	DIN 934 M 8	Hexagon nut	6
15	520-15.644	Brake plate single	1
18	520-15.608	Brake spindle	1
19	267-05.597	Washer	1
20	405-15.388	Sealing ring	1
21	520-15.632	Brake lever	1
22	DIN 936 M 8x1	Hexagon nut	1
23	517-15.609	Brake shoe (1 pair)	1
24	517-15.133	Draw spring	2
25	520-15.613	Chain tensioner left	1
26	433-15.131	Nut	1
27	DIN 933 M 7x50	Hexagon bolt	2
28	DIN 934 M 7	Hexagon nut	2
29	520-15.614	Chain tensioner right	1
30	520-15.650	Strip	1
32	DIN 125 A 8,4	Washer	1
33	520-15.150	Spring clip	1
34	DIN 933 M 8x22	Hexagon bolt	1
35	561-17.111	Locking nut M 8x1	1
36	520-15.206	Knock-out spindle 15 mm ϕ	1
38	519-18.607	Chain with lock, 1/2x5/16" 114 links	1

Electrical equipment

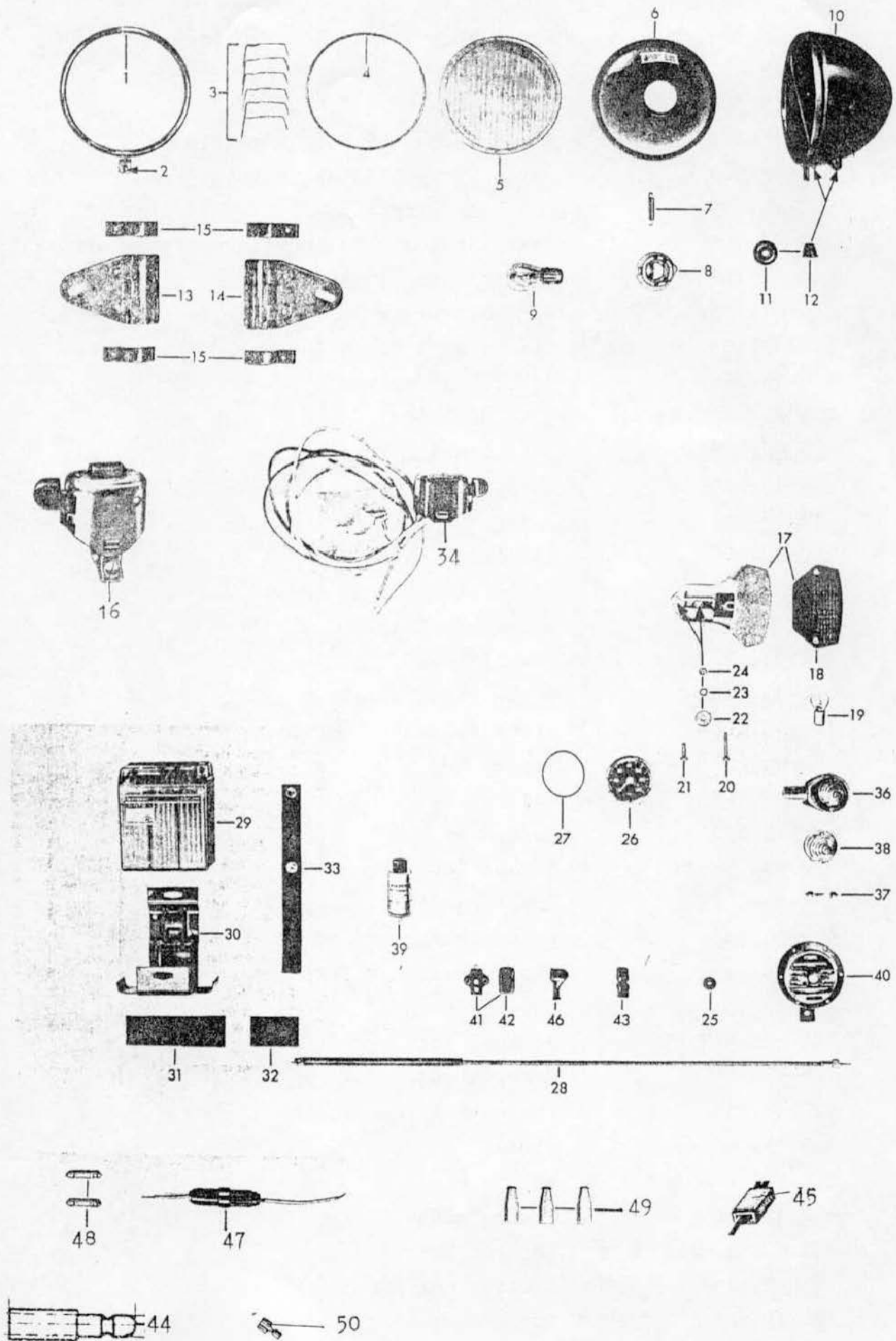

Jll.-No.	Order No.	Description	Piece
1-8	517-16.743	Headlamp insert cpl. (without bulb)	1
1	517-16.927	Lens retaining ring cpl.	1
2	519-16.901	Locking screw	1
3	517-16.933	Spring (piece)	6
4	517-16.928	Gasket	1
5	517-16.929	Glass	1
6	517-16.930	Reflector	1
7	517-16.931	Draw spring	1
8	517-16.932	Lamp holder	1
9	DIN 72601 6V-35/35 W	Bulb	1
10	517-16.742 <u>colour</u>	Headlamp casing cpl.	1
11	520-16.914	Cable sleeve	1
12	520-16.915	Cable sleeve	1
13	520-16.604 <u>colour</u>	Headlamp holder left	1
14	520-16.605 <u>colour</u>	Headlamp holder right	1
15	520-16.655 <u>colour</u>	Clamping	4
--	DIN 933 M 6x16	Hexagon bolt (for clamping)	4
--	DIN 933 M 8x18	Hexagon bolt (for holder)	2
--	DIN 9021 A 8,4	Washer	2
--	DIN 125 A 6,4	Washer	4
16	517-16.935 517-16.750	Light switch	1
17	520-16.701	Rearlight cpl. (without bulb)	1
18	520-16.900	Light outlet cpl.	1
19	DIN 72601 SL 6V,21-5W	Bulb	1
20	DIN 84 AM 6x35	Cylinder bolt	1
21	DIN 85 AM 6x16	Lens head screw	1
22	1301 z 1019	Washer	2
23	DIN 127 B 6	Spring washer	3
24	DIN 934 M 6	Hexagon nut	2
25	M 1806 z 59	Cable sleeve	1
26	519-16.724	Speedometer	1
27	517-16.100	Gasket	1
28	520-16.607	Speedometer flexible shaft 885 mm long	1
29	6060 z 107	Battery 6 V - 8 Ah	1
30	520-16.665	Battery holder	1
31	520-16.117	Rubber plate 40x140x4 mm	1
32	520-16.118	Rubber plate 40x 67x4 mm	1
33	521-16.600	Rubber band	1
34	520-16.741	Flasher switch	1
36	500-16.703	Flasher lamp, without bulb	2
37	DIN 72601 K6V-18 W	Bulb	2
38	500-16.901	Glass lens	2
--	500-16.902	Locking screw	} for Lass lens
--	DIN 85 AM 3x10	Oval-head screw	
39	521-16.604	Flasher unit	1
40	520-16.766	Horn	1
41	520-16.725	Stop light switch	1
42	520-16.901	Protecting cap	1
43	518-16.130	Rectifier	1
44	520-16.255	Round plug	2
45	686-16.129	Connecting piece	1
46	520-16.257	Protecting cap	2
47	6160 z 237	Cable coupler	1
48	DIN 72581 8	Fuse	2
49	304-07.276	Plug sleeve	6
50	DIN 46247 6,3x1	Plug sleeve	10
--	304-07.260	Plug housing	1
--	304-07.249	Plug sleeve 19,1 mm length 0,3 mm thick	5

Handelbar, operating levers and controls, cables

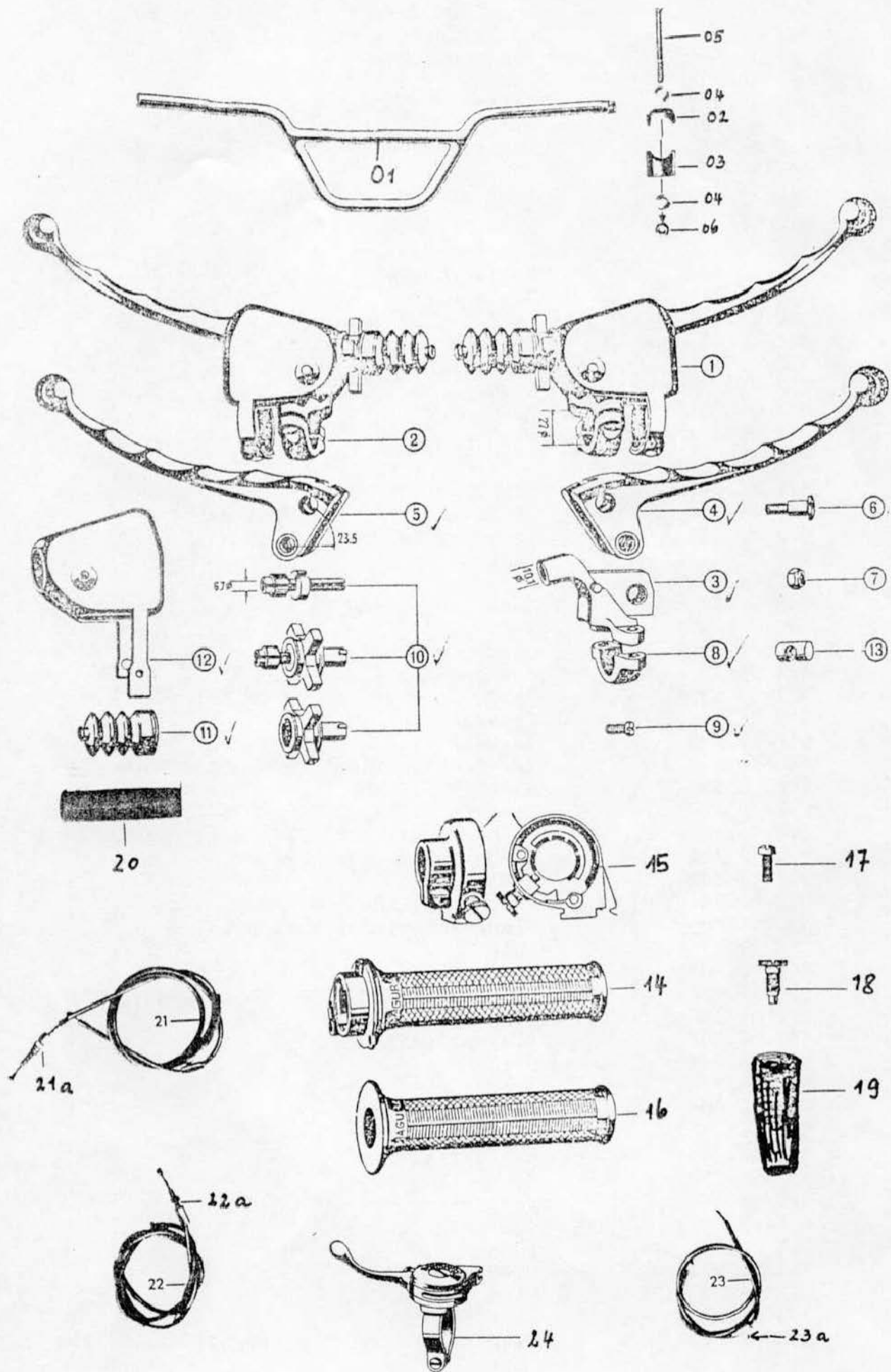

Jll.-No.	Order No.	Description	Piece
01	520-13.604	Handlebar	1
02	520-13.131	Mounting bracket, top	2
03	520-13.132	Mounting bracket, bottom	2
04	DIN 125 A 8,4	Washer	2
05	DIN 931 M 8x75	Hexagon bolt	2
06	561-17.111	Locking screw M 8	2
1	510-17.727	Brake lever cpl.	1
2	510-17.726	Clutch lever cpl.	1
3	520-17.909	Joint	1
4	520-17.910	Hand lever vor brake	1
5	520-17.911	Hand lever for clutch	1
6	520-17.912	Lever screw	2
7	520-17.913	Locking nut	2
8	520-17.914	Cover	2
9	520-17.915	Oval-head screw	2
10	520-17.916	Adjuster screw	2
11	519-17.906	Bellow	2
12	520-17.917	Protecting cap	2
13	520-17.918	Support f. soldered nipple	2
--	520-17.718	Throttle twist grip cpl.	1
14	520-17.919	Grip tube cpl.	1
15	520-17.921	Housing cpl. [^]	1
16	520-17.920	Grip cover	1
17	400-17.912	Oval-head screw	1
18	520-17.922	Knerled screw with compression spring	1
19	520-17.923	Protecting cap	1
20	516-17.705	Fixed grip	1
21	520-17.620	Bowden cable for brake cpl. A 1,6x1245 mm	1
21a	428-17.715	Adjuster screw cpl.	1
22	520-17.621	Bowden cable for clutch cpl. A 1,6x1145 mm	1
22a	515-17.715	Adjuster screw	1
23	520-17.634	Bowden cable f. throttle cpl. A 1,6x1106 mm	1
23a	428-17.635	Plastic oiler	4
--	520-17.627	Starter cable cpl. A 1,6 x 990 mm long	1
24	520-17.717	Starter lever cpl.	1
--	685-36.187	Retaining clip	4

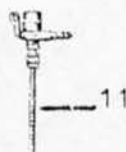
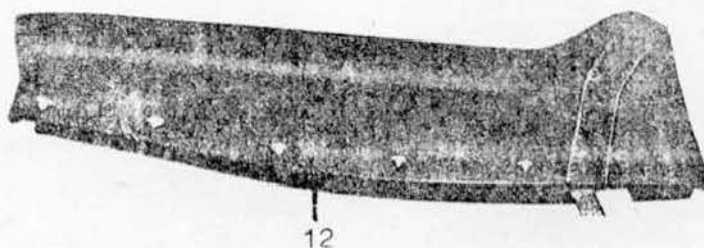
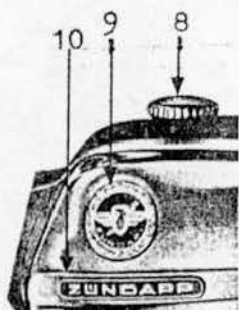
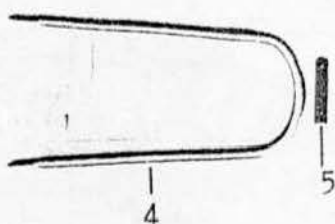
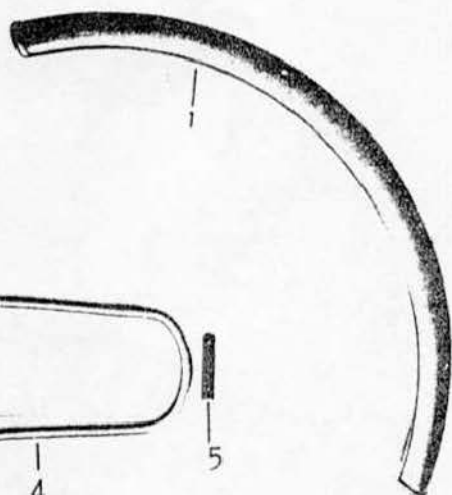
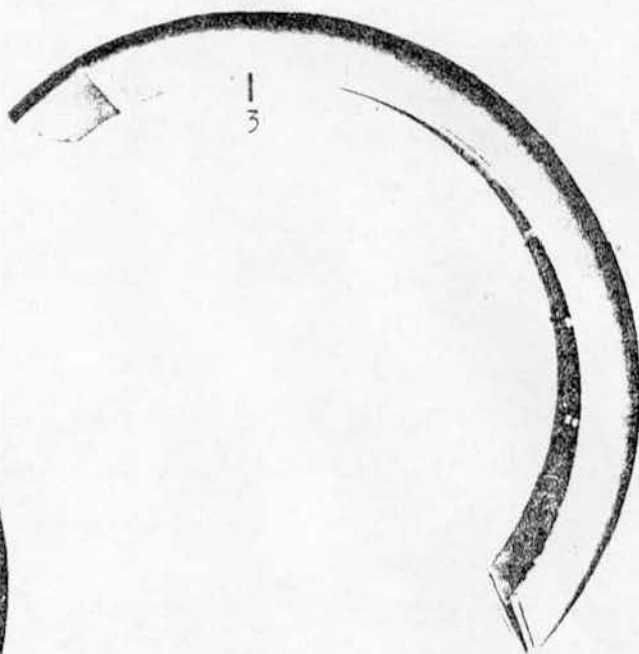
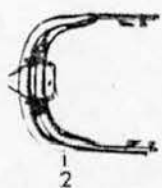

Jll.-No.	Order No.	Description	Piece
1	520-19.162	Front wheel mud gurad	1
2	520-19.635	Mounting bracket, top	1
3	520-19.630	Rear wheel mud guard	1
4	520-19.634	Mounting bracket, bottom	1
5	517-19.124	Distance piece	1
-	520-19.151	Plastic plate 400 mm long, 1 mm thick	1
-	520-19.608	Holder for Rear wheel mud guard	1
-	600 z 5	Swing suspension buffer	3
-	DIN 933 M 6x16	Hexagon bolt	18
-	DIN 125 A 6,4	Washer	11
-	DIN 933 M 6x25	Hexagon bolt	2
-	517-22.111	Locking nut M 6	13
-	517-21.114	Rubber washer 6,5x20x3,5 mm	17
-	1301 z 1019	Washer	3
-	DIN 934 M 6	Hexagon nut	8
6	520-19.108	Number plate bracket	1
7	520-20.718 <u>colour</u>	Fuel tank cpl. (without fuel tap)	1
8	432-20.610	Tank cap	1
9	440-20.100	Plaque	2
10	520-20.176	Plaque	2
11	434-20.703	Fuel tap cpl.	1
--	DIN 73379 Sy.390	Fuel tube (plastic A 5x9x290 mm long)	1
--	520-20.145	Bush ϕ 11,5x20x22 mm	2
--	520-20.167	Bush 8,2 mm ϕ	2
--	DIN 931 M 8x40	Hexagon bolt	2
--	520-40.288	Swing suspension buffer	1
--	520-20.179	Bush 8,6x22x15 mm	1
--	DIN 551 M 8x35	Pin	1
--	DIN 934 M 8	Hexagon nut	4
--	520-20.705	Tool kit	1
--	520-20.619	Box spanner SW 22	1
12	520-21.623	Bench seat	1
--	512-21.701	Mirror cpl.	1
--	512-21.100	Clamping piece	1

Some illustrations are not identical
with the parts.

1/8 kilo tin repair varnish

Order No. 005-02.060 racing-red

005-02.038 racing-silver, for fairings



IMPORTANT:

Only original ZUNDAPP spare parts ensure absolute reliability and safety of your vehicle, prevent damage and maintain the validity of our Guarantee. Use only genuine ZUNDAPP spare parts and no imitated parts. Remember that the fitting of spare parts of other makes invalidates our Guarantee.

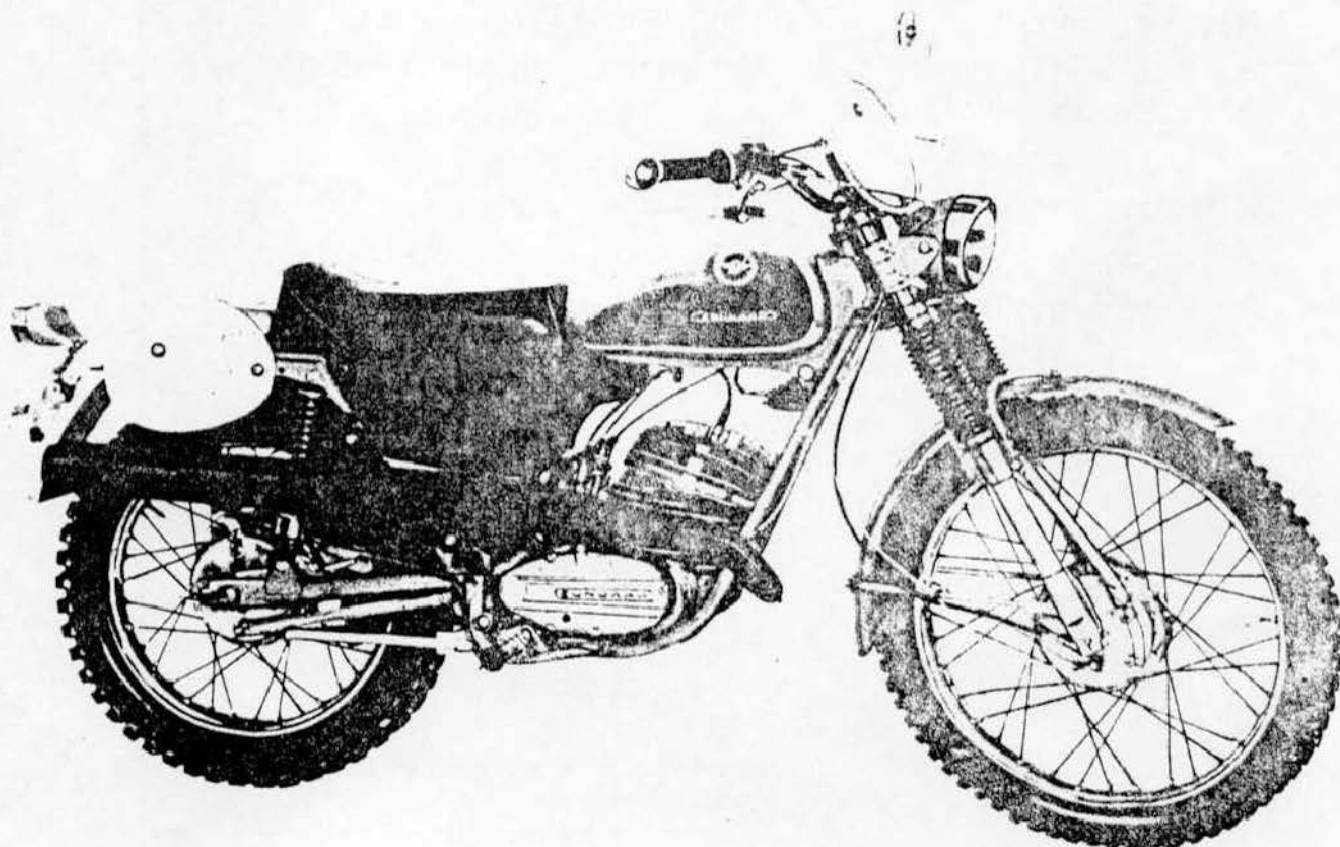

ZUNDAPP GS 125



ZUNDAPP-WERKE GMBH · 8 MÜNCHEN 80 · Anzinger Str. 1-3